

FILE NO:

VER	DATE	UPDATE	APPD

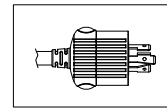

NEMA L6-30P 30A/208V-

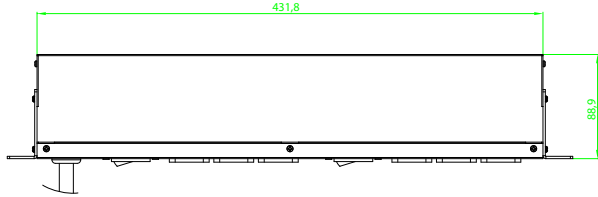
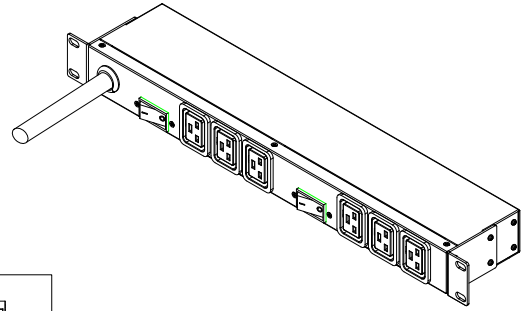
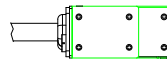
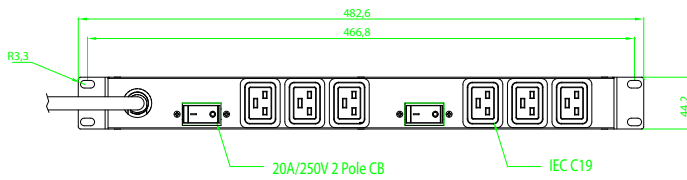

Part Number.....ePBZ94
 Mounting.....Horizontal (1U)
 Over Current Protection.....CB-2P/20A (UL489)
 Power Switch.....N/A
 Rating.....24A / 208Vac
 Input.....NEMA L6-30P
 Outlet.....IEC320 C19x6
 Power Cord.....10AWG X 3C 6ft
 UL Standard.....UL60950-1
 Certification.....UL / cUL

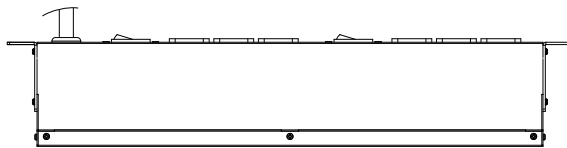

DRAWN	NAME	DATE	DIMENSION TOLERANCE	MATERIAL	
VNC		2009-10-20	±0.3	N/A	ePBZ94
TYC		2009-10-20	±0.1		
APPD	JSL	2009-10-20	±0.010	SHEET	PART NO: ASM-CA-R175-06
SCALE: -	VERSION: -			CF	DRAW NO: M-0929